

HANDRAIL CUT LIST

RAIL	LENGTH	# & Notes
R1	5'-7 3/4"	2
R2	5'-9 1/4"	2
R3	2'-11"	2
R4	7'-10 1/8"	2 (1 tenoned end ea.)
R5	9'-4 1/4"	2
R6	11'-9"	2
R7	2'-3"	2
R8	2'-7"	2 (1 tenoned end ea.)
R9	10'-2 1/4"	2
R10	3'-2 1/2"	2
R11	3'-10"	2 (1 tenoned end ea.)
R12	7'-3 3/4"	2

R13	6'-6 3/4"	2
R14	13'-1 1/2"	2
R15	6'-6 3/4"	2
R16	7'-3 3/4"	2
R17	10'-2 1/4"	2
R18	2'-10 1/2"	2
R19	11'-9"	2
R20	11'-9"	2
R21	3'-9"	2
R22	5'-3 3/4"	2
R23	6'-1 1/4"	2
R24	7'-10"	2 (1 tenoned end ea.)

RAILS NOT INSET IN POSTS SHOULD BE ATTACHED TO POST W/CORNER IRON ON BOTTOM AND TOENAIL ON TOP.

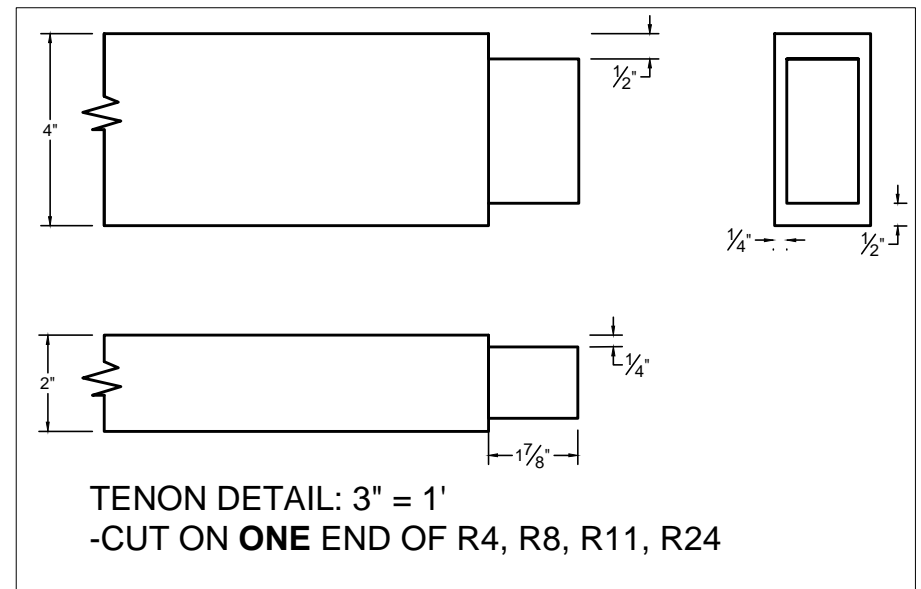

UVA DRAMA
SHIPWRECKED

DIRECTOR: MARIANNE KUBIK
DESIGNER: BATUL RIZVI
TD: TIM NIELSEN
DRAFTED BY: JD STALLINGS

GALLEY PLATFORM
HANDRAILS
TOP/PLAN VIEW
WITH TENON DETAIL

1/4" = 1'

DRAWING NOTES:

- ALL RAILINGS ARE ROUGH CUT 2"X4"
- USE 3" ROBERTSON SCREWS TO ATTACH INSET RAILS
- *STAIR RAILS NOT SHOWN*

3/13/17

5.3.4
OF 20

